

## Opportunities in Tamil Nadu

### Biotechnology

Tamil Nadu is rich in biological resources with forest cover of 52,500 sq.km, plant resources of 5,000 species and 1,000 km coastal line.

Large pool of scientific talent - IIT, Anna University, University of Madras, Agricultural University, Veterinary University, etc. and 630 Engineering Colleges, 500 Polytechnics and 1,600 Industrial Training Institutions.

### Key Strengths

Fastest growing State Economy in India & Pro-active State Policy. Large pool of Scientific talent available at a reasonable cost. Access to biological materials, new technologies, process and knowledge through collaborative technology networking with leading National - International Universities and Research Institutes. Industry academic partnership for strategic research, product planning and contract research.

### Bio Technology Policy 2014

Vision 2023 of Tamil Nadu Government identified Biotechnology as sunrising sector for creating scientific and research networks for commercialization.

Bio Policy 2014 proposes National Centre for Excellence / Bio R&D Institute, Bio IT Park, Medical Bio Industrial Cluster, Bio Research Fund, Biotech Venture Capital Bio Parks/Bio Incubators in Tier II Cities, Viz. Coimbatore, Madurai, Trichy, etc., Single Window Facilitation.

### Initiatives of TIDCO

Tamil Nadu Industrial Development Corporation Ltd., (TIDCO) created sector specific Bio parks with common infrastructure - facilities to minimise capital investment by individual Industries.

### TICEL BIO PARK - III, Coimbatore

Hon'ble Chief Minister has laid foundation stone on 29.01.2016 for establishing TICEL Bio Park - III in Anna University Campus, Coimbatore.

Plot Area	: 10 acres
Main Building	: Ground + 13 floors
Built up area	: 2,14,000 sq.ft.
Project Cost	: Rs.550 millions
Project Completion	: June 2018

## Hon'ble Chief Minister inaugurated TICEL Bio Park II on 9.9.2015

### PROJECT FEATURES

Project Cost	: 1680 Millions INR
Built-up area	: 6,30,000 sq.ft.
Lab Space (BSL2/BSL3)	: 4,00,000 sq.ft.
Parking & Commercial	: 2,30,000 sq.ft.
Location	: Off - IT Expressway
Airport (Chennai)	: 12 kms.
Railway Station	: MRTS Nearby
Sea Port (Chennai)	: 12 kms.
Plot Area	: 5 Acres
Lease Period	: 3 /5/10/15/20/30 Years
Car Parking	: 750 Cars

Lab Infrastructure : 100% Fresh A/c, Compressed Air, Vacuum, RO Water, 100% Power Backup, STP / ETP, etc.,

Activities : Biotechnology, Pharmaceutical, Bio IT, Nanotechnology, R&D Activities.

Biotechnology Core Instrumentation Facility (BTCIF) established jointly by TICEL and Department of Biotechnology, Gol for providing scientific supports at a cost of Rs.193 millions.



**TICEL BIO PARK-II**

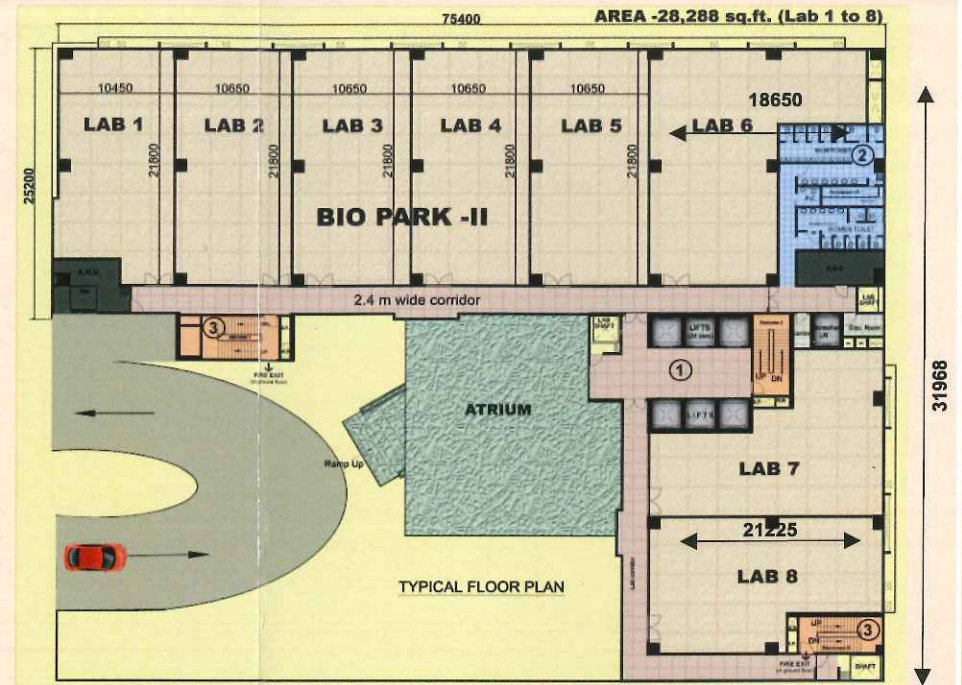

### TYPICAL LAB FLOOR (8 MODULES) IN BIO PARK - II (Area in sq.ft.)

Area	LAB-1	LAB-2	LAB-3	LAB-4	LAB-5	LAB-6	LAB-7	LAB-8	TOTAL
Carpet	2,421	2,569	2,569	2,569	2,569	3,438	2,590	2,592	21,317
Super Built up	3,213	3,409	3,409	3,409	3,409	4,563	3,436	3,440	28,288

